



Meaningful Innovation.

WEEE Number: 80133970

# INSTRUCTION MANUAL

## WATER PROOF TERMINAL BLOCK



### TECHNICAL DATA

MODEL	VT-868	
SKU	5977, 5986	
RATED POWER	24A, 450VAC	
MATERIAL	HOUSING	CONDUCTOR
	Nylon	Brass
CORE	4P	
WORKING	T105	
RATED CONNECTING CAPACITY	0.5~2.5mm <sup>2</sup>	

REFER TO STRIPPING LENGTH	External Stripping 22mm Internal Stripping 6mm
AVAILABLE CABLE DIAMETER (RUBBER)	4-8mm/6-11mm (Rubber Cable)
TESTING	20M 150 Hours
DIMENSION	75.8mm x 24.60mm

**IP68**  
**RATING**

**03**  
**YEAR**  
**WARRANTY\***

### INTRODUCTION & WARRANTY

Thank you for selecting and buying V-TAC product. V-TAC will serve you the best. Please read these instructions carefully before starting the installation and keep this manual handy for future reference. If you have any another query, please contact our dealer or local vendor from whom you have purchased the product. They are trained and ready to serve you at the best. The warranty is valid for 3 years from the date of purchase. The warranty does not apply to damage caused by incorrect installation or abnormal wear and tear. The company gives no warranty against damage to any surface due to incorrect removal and installation of the product. This product is warranted for manufacturing defects only.

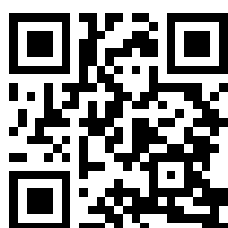

#### MULTI-LANGUAGE MANUAL QR CODE

Please scan the QR code to  
access the manual in multiple languages.

In case of any query/issue with the product, please reach out to us at: [support@v-tac.eu](mailto:support@v-tac.eu)  
For More products range, inquiry please contact our distributor or nearest dealers.  
V-TAC EUROPE LTD. Bulgaria, Plovdiv 4000, bul.L.Karavelow 9B



This marking indicates that this product should not be disposed of with other household wastes.



Caution, risk of electric shock.

## **WARNING**

1. Please make sure to turn off the power before starting the installation.
2. Installation must be performed by a qualified electrician.

## **PRODUCT PARTS**



## **DIMENSIONS**

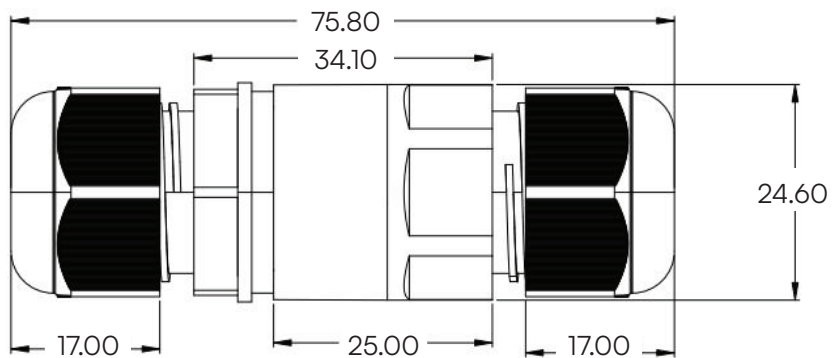

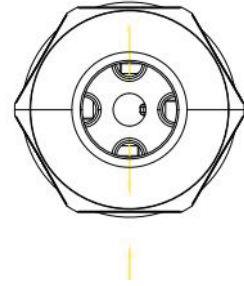
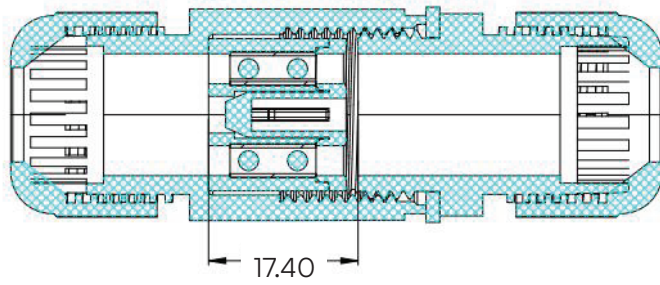

**REFER TO STRIPPING LENGTH**

0.5mm<sup>2</sup> - 2.5mm<sup>2</sup>

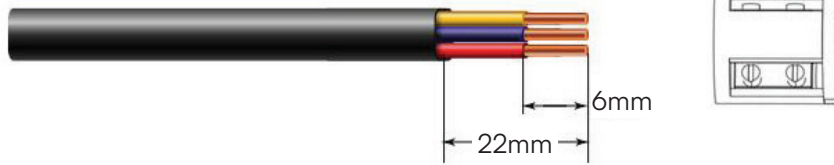

**INSTALLATION INSTRUCTIONS**



1 Open the nut cover at both end sides, Take out the quick connector

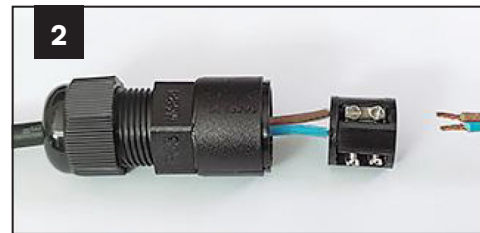

2 Thread the cable through the nut

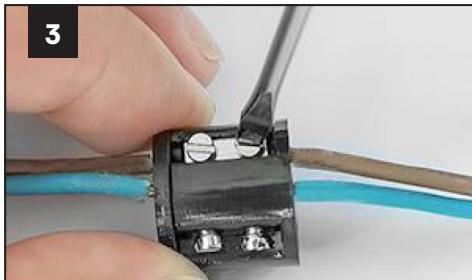

3 After the wire is inserted into the inner core of the wiring, the screw is fixed.



4 Connect the wires and tighten the sleeves and nuts at both ends



5 Twist and tighten the cable glands

